

FOR LEASE: 5,000 - 49,770 SQUARE FEET
2010-2044 N. STATE HWY 360, GRAND PRAIRIE

INDUSTRIAL REAL ESTATE BROKERAGE

WWW.MERCER-COMPANY.COM

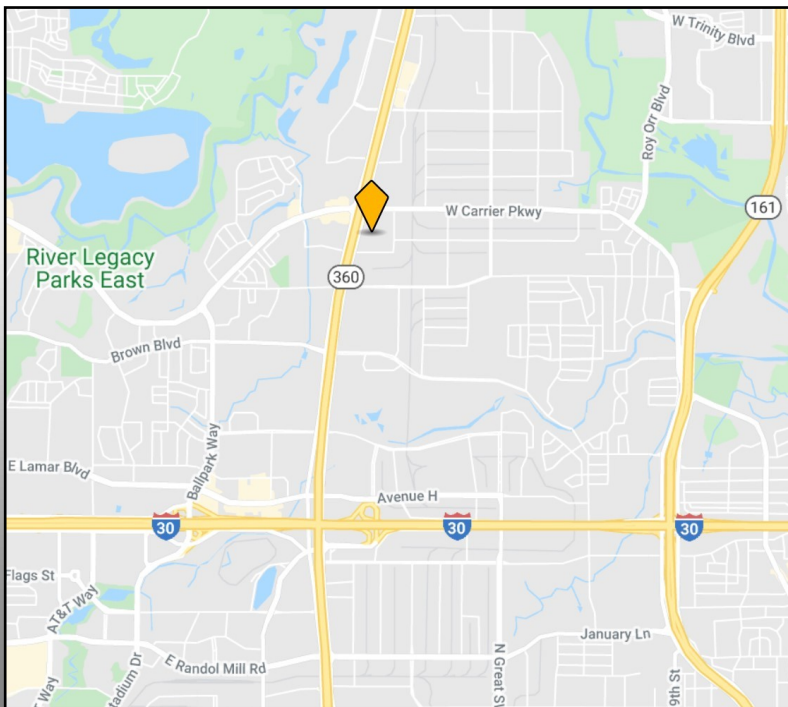
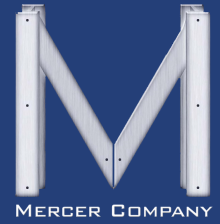

DETAILS

AVAILABLE FOR LEASE

- ◆ TOTAL SF: ±5,000 - 49,770
- ◆ 93% OFFICE
- ◆ CLEAR HEIGHT: 18'
- ◆ POSSIBLE DOCK HIGH LOADING
- ◆ SPRINKLERS
- ◆ HWY 360 FRONTAGE
- ◆ AMPLE PARKING
- ◆ 10 MILES TO DFW INT. AIRPORT
- ◆ 19 MILES TO LOVE FIELD
- ◆ GREAT LABOR POOL
- ◆ FIBER AVAILABLE
- ◆ GREAT CENTRAL LOCATION IN DFW

CORBY HODGKISS

CELL 469.360.3918

CHODGKISS@MERCER-COMPANY.COM

FOR LEASE: 5,000 - 49,770 SQUARE FEET
 2010-2044 N. STATE HWY 360, GRAND PRAIRIE

INDUSTRIAL REAL ESTATE BROKERAGE

WWW.MERCER-COMPANY.COM

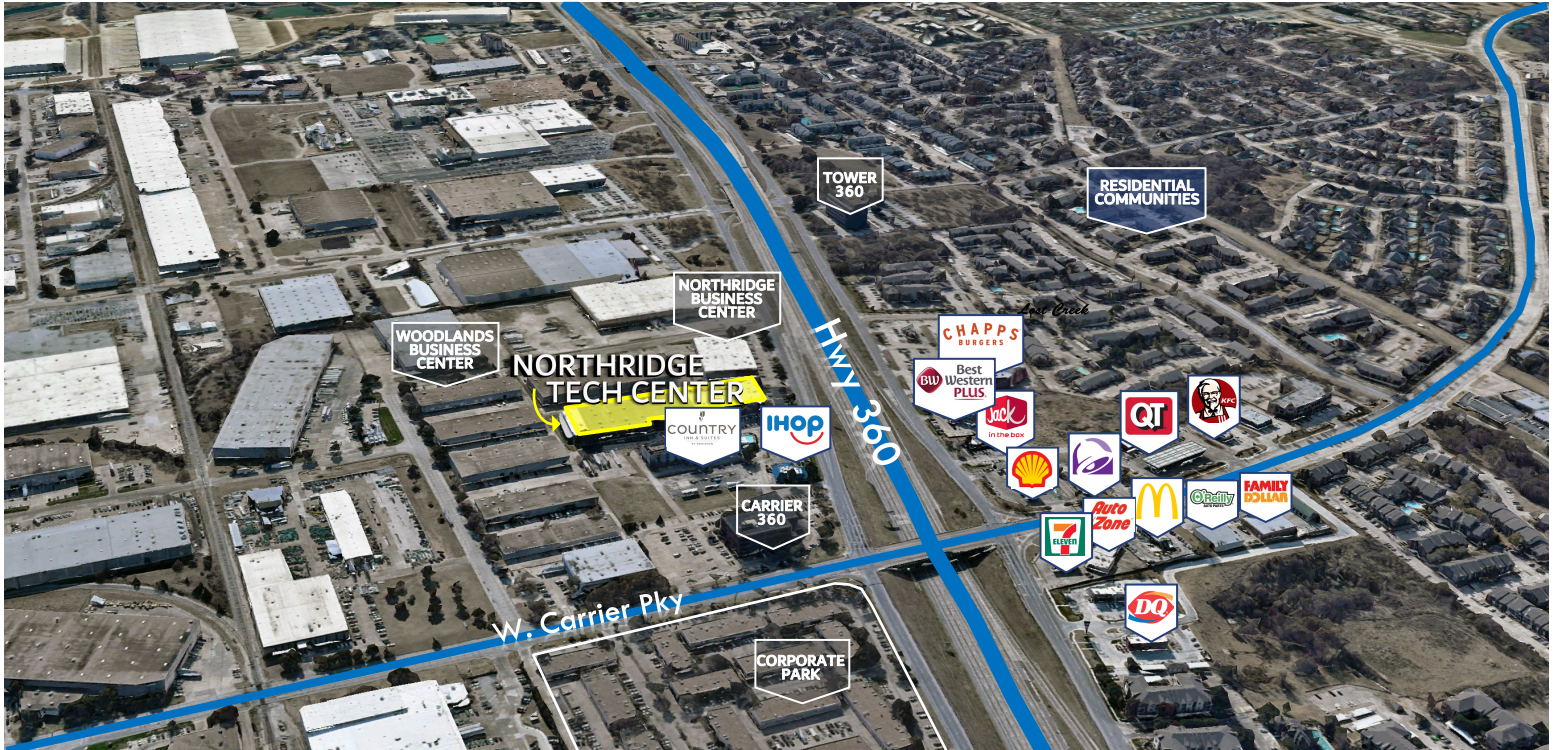
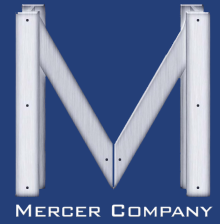

NORTHRIDGE TECH CENTER

Suite 2030
 Total SF: ±5,000
 60% Office
 Clear Height: 18'

Suite 2032
 Total SF: ±9,660
 100% Office
 Clear Height: 18'

Suites 2040-2042
 Total SF: ±21,007
 100% Office
 Clear Height: 18'

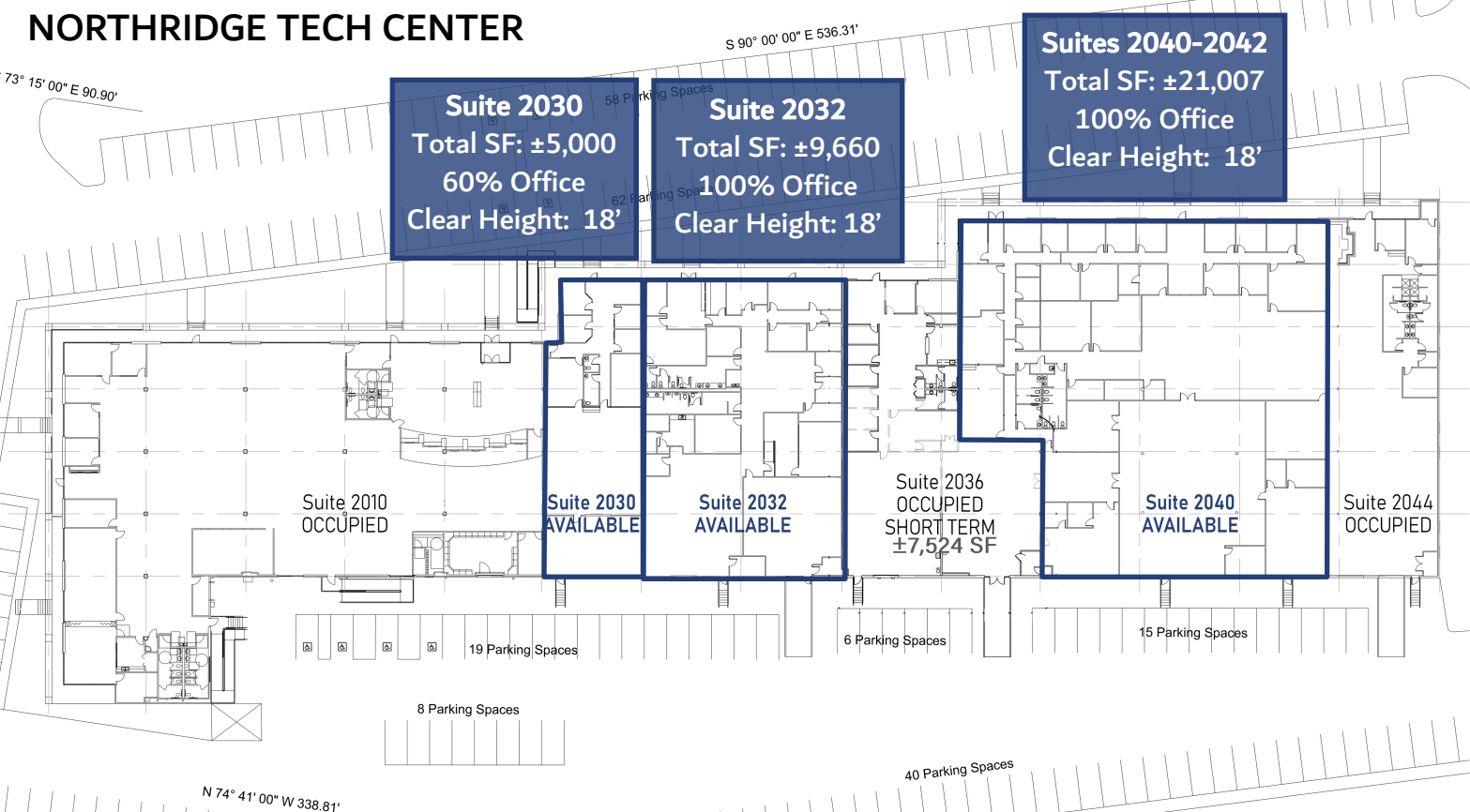

The information contained herein has been given to us by sources we deem reliable and to the best of the Landlord's knowledge. We have no reason to doubt its accuracy, but we do not guarantee it. All information should be verified before lease."